

P:\11\NORTHBRIDGE GYM 1ST FL PAVILION - 10000007-PT-100.dwg, 3/20/21 1:58:07 PM, 11

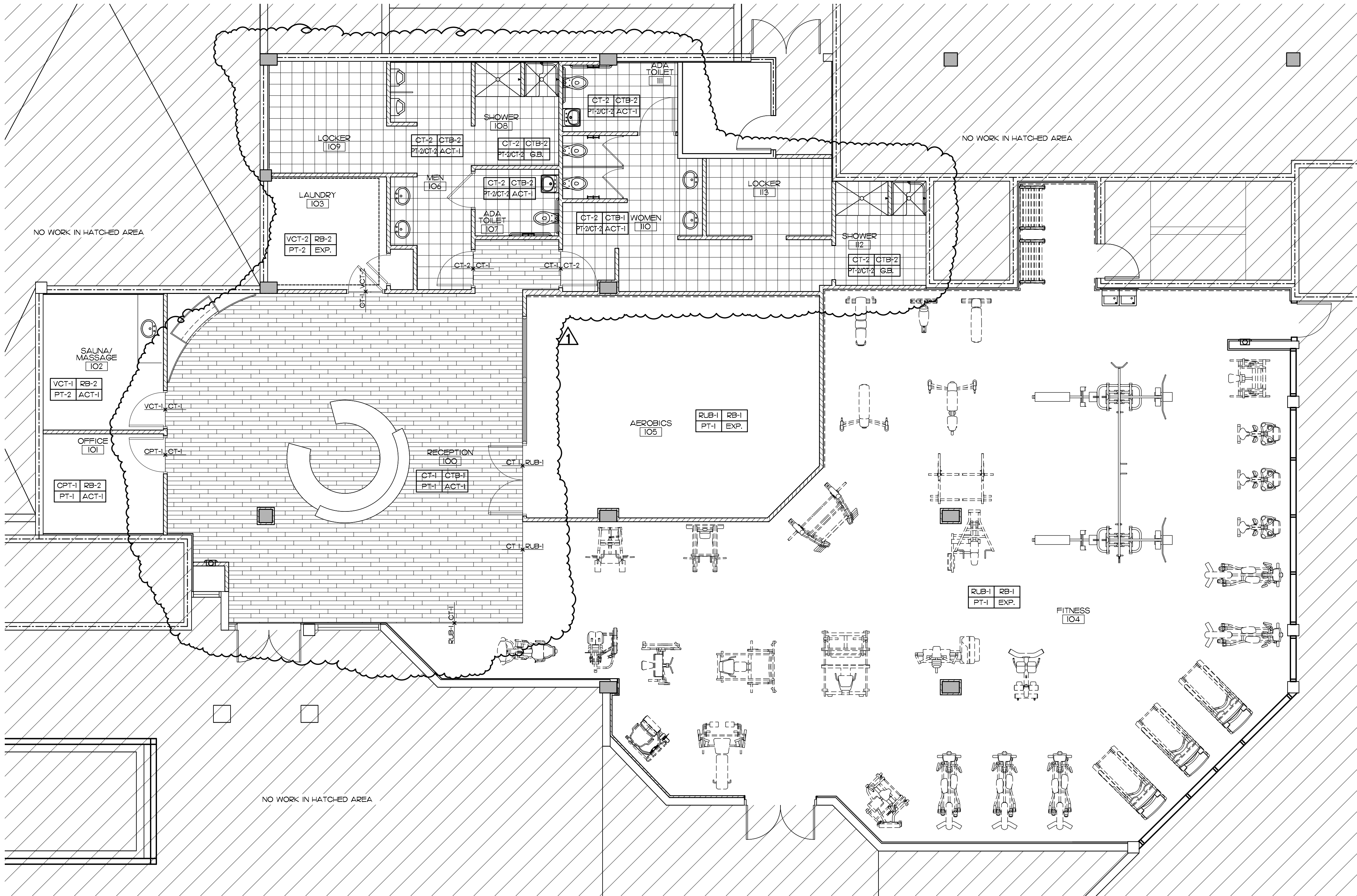

1 FINISH PLAN
SCALE: 3/16"=1'-0"

FINISH SPECIFICATIONS

GENERAL NOTE:

GLIDDEN SPINA AND PARTNERS SHALL QUALIFY GENERAL CONTRACTORS AND SUBCONTRACTORS FOR WALLCOVERING, CARPET AND TILE FINISHES.

FLOOR

- CONTRACTOR SHALL REMOVE EXISTING FLOOR COVERING, AND PREPARE CONCRETE SLAB TO ACCEPT FLOOR FINISHES AS PER FINISH SCHEDULE. AT MATERIAL TRANSITIONS, CONTRACTOR TO PROVIDE LEVELING TO EXTEND 2' TO CREATE GRADUAL SLOPE AND TRANSITIONS SHALL NOT BE GREATER THAN 1/8".
- FINISH TO BE WITHIN 1/8" IN 10' UNLESS OTHERWISE APPROVED IN NON-CIRCULATION AREAS.
- PROVIDE SLAB FLASHING AT TRANSITION BETWEEN TILE AND CARPET WITH 1/8" PER FOOT MAX. SLOPE.
- CARPET SHALL BE INSTALLED WITH ATTACHED TREAD AND PAD. MANUFACTURER/TBS
- CONTRACTOR SHALL PROVIDE TRANSITION STRIPS AS MANUFACTURED BY SCHLUTER AT TILE/CARPET TRANSITIONS, MODEL #AE225.
- AT MATERIAL TRANSITIONS, SUBCONTRACTOR TO PROVIDE LEVELING TO EXTEND 6' TO CREATE A GRADUAL SLOPE AND TRANSITIONS SHALL NOT BE GREATER THAN 1/8".
- SUBCONTRACTOR SHALL PROVIDE SEAMING DIAGRAM TO DESIGNER FOR APPROVAL. CARPET SHALL BE TREATED WITH A STAIN GUARD, AS REQUIRED.
- CARPET 1 - (CT-1) OWNER TO SELECT. G.C. TO PURCHASE & INSTALL.
- ACTUAL MATERIAL SHALL BE SELECTED BY OWNER PRIOR TO INSTALLATION. MANUFACTURER/TBS
- VINYL COMPOSITION TILE 12" X 12", STANDARD EXCELON COLOR TO BE SELECTED BY INTERIOR DESIGNER, IMPERIAL TEXTURE, THICKNESS.
- VINYL COMPOSITION TILE 1 - (VCT-1) OWNER TO SELECT. G.C. TO PURCHASE & INSTALL.
- VINYL COMPOSITION TILE 2 - (VCT-2) OWNER TO SELECT. G.C. TO PURCHASE & INSTALL.
- CERAMIC TILE
- ACTUAL MATERIAL SHALL BE APPROVED BY OWNER PRIOR TO INSTALLATION. MANUFACTURER/TBS
- CERAMIC TILE 1 - (CT-1) MANUF. ATLAS CONCORDE, MODEL: ETIC LIVO, 9"x9" RECTIFICATION, G.C. TO PURCHASE & INSTALL.
- CERAMIC TILE 2 - (CT-2) OWNER TO SELECT. G.C. TO PURCHASE & INSTALL.
- RUBBER
- ACTUAL MATERIAL SHALL BE APPROVED BY OWNER PRIOR TO INSTALLATION.
- RUBBER 1 - (RUB-1) MANUF. ECO SURFACES' MODEL ECO NIGHTS FOR SPORT, COLOR: #601 NR.
- SLATE (RUB-1) G.C. TO PURCHASE & INSTALL.

BASE

- ALL WOOD SHALL BE FINISHED BY A QUALITY AMI WORKSHOP.
- ALL MILLWORK SHALL BE FACTORY FINISH.
- FINISH SAMPLE SHALL BE SUBMITTED TO INTERIOR DESIGNER FOR APPROVAL PRIOR TO FABRICATION.
- BASE/TRIM SHALL BE TOUCHED UP AFTER CARPET IS INSTALLED.
- RUBBER BASE
- RUBBER BASE- 4" CONTINUOUS COVE BASE WITH 1/2" ROUNDED CORNERS. MANUFACTURER/TBS
- RUBBER BASE 1 - (RB-1) OWNER TO SELECT. G.C. TO PURCHASE & INSTALL.
- RUBBER BASE 2 - (RB-2) OWNER TO SELECT. G.C. TO PURCHASE & INSTALL.
- CERAMIC TILE BASE, MATERIAL AND INSTALLATION BY MANUFACTURER/ARTISANS.
- ACTUAL MATERIAL SHALL BE APPROVED BY TENANT/ DESIGNER PRIOR TO INSTALLATION.
- CERAMIC TILE BASE 1 - (CTB-1) OWNER TO SELECT. G.C. TO PURCHASE & INSTALL.
- CERAMIC TILE BASE 2 - (CTB-2) OWNER TO SELECT. G.C. TO PURCHASE & INSTALL.

WALL

- GYP-SUM BOARD- SMOOTH SLICK FINISH (LEVEL 4, SMOOTH TEXTURE) READY TO RECEIVE PAINT OR SMOOTH FINISH READY TO RECEIVE WALLPAPER.
- NEW WALL FINISH TO LEVEL TO MATCH EXISTING WALL.
- PAINT
- 2 COATS OF PAINT- SEE SCHEDULE AND INTERIOR ELEVATIONS FOR LOCATIONS PROVIDE WALL SAMPLE FOR DESIGNER APPROVAL.
- PAINT #1 - (PT-1) FINISH WASHABLE FLAT, COLOR TO BE SELECTED BY OWNER.
- PAINT #2 - (PT-2) COAT OF PREPRITE 200 LATEX PRIMER AND 2 COATS OF WATER BASED CATALYZED EPOXY PAINT. COLOR TO BE SELECTED BY OWNER.
- CERAMIC TILE
- ACTUAL MATERIAL SHALL BE APPROVED BY OWNER PRIOR TO INSTALLATION. MANUFACTURER/TBS
- CERAMIC TILE 2 - (CT-2) OWNER TO SELECT. G.C. TO PURCHASE & INSTALL.

CEILING

- ALL BULKHEADS OR SOFFITS SHALL BE PAINTED.
- CONTRACTOR TO LAYOUT CEILING GRID AS SHOWN ON PLAN.
- REGULAR EDGES IN ANY VISIBLE AREAS CONTAINING LINEAR AIR BARS, LIGHTS AND SOFFITS SHALL BE FACTORY PAINTED.
- PAINT
- 2 COATS OF PRIMER 200 LATEX FLAT WALL PAINT ON ALL GYPSUM BOARD & EXPOSED CEILINGS AS NOTED ON PLAN, COLOR TO BE SELECTED BY OWNER.
- PAINT #3 - (PT-3) FINISH WASHABLE FLAT, COLOR TO BE SELECTED BY OWNER.
- ACOUSTICAL CEILING- ARISTON
- TILE - H (ACT-1) "DUNE" 1174, 2X2 BEVELED TEGULAR EDGE, WHITE W/ 15/16" PRELUDE XL GRID, COLOR: WHITE HUMIGARD PLUS, BIOBLOCK, NRC .50, 15 YR. WARRANTY.

LAMINATE

- COUNTERTOPS
- CABINETS (FACE TO BE SOLID COLOR MATTE FINISH OR EQUAL)- MANUF. COLOR TO BE SELECTED BY OWNER.

TOILET PARTITIONS

- MANUF. BOBICK, MODEL: DURALINE 1060 SERIES FLOOR ANCHORED, COLOR TO BE SELECTED BY OWNER.

WOOD

- STAIN GRADE, COLOR TO MATCH OWNER'S SAMPLE, SUBMIT SAMPLE FOR APPROVAL PRIOR TO FABRICATION.

WINDOW TREATMENTS

- WINDOW TREATMENTS - G.C. TO PURCHASE & INSTALL.
- SOLAR SHADES, MANUFACTURER: PHIFER, INC. SHEERWEAVE #2360, BLACK, OPENNESS FACTOR: 10%.

COVER PLATES

- COLOR: WHITE

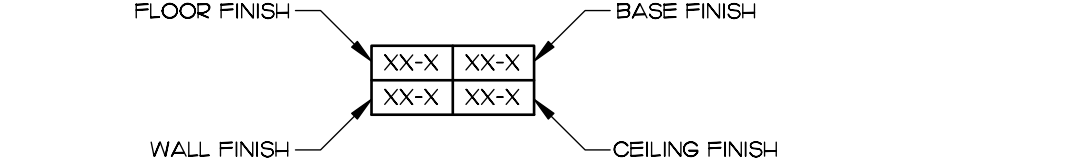

*** REFER TO INTERIOR ELEVATIONS AND PARTIAL ENLARGED FLOOR PLANS FOR ADDITIONAL INFORMATION - CONTACT ARCHITECT IF CONFLICT ARISES

WALL LEGEND

1	EXISTING EXTERIOR WALL
2	NEW PARTITION SEE DETAIL 4/A-3.0
3	EXISTING 1-HR RATED DEMISING WALL. G.C. SHALL CHECK ALL EXISTING RATED WALLS TO MAKE SURE THAT THE REQUIRED WARNING SIGNAGE IS PAINTED ABOVE CEILING. IF NOT THE CONTRACTOR SHALL PAINT ABOVE THE CEILING TO BE VISIBLE FIRE AND SMOKE BARRIER PROTECT ALL OPENINGS
5	EXISTING PARTITION TO REMAIN-GC TO PATCH AND REPAIRS WALLS TO RECEIVE PAINT
7X	DOOR NUMBER
FEC	FIRE EXTINGUISHER CABINET - SEE DETAIL 15/A-3.0
NEW	NEW CEILING MOUNTED EXIT LIGHTS AS REQ'D - SEE ELECTRICAL DRAWINGS

FLOOR & REF.CLG.PLAN 1ST FLOOR - PAVILION

SCALE: 1/8" = 1'-0"

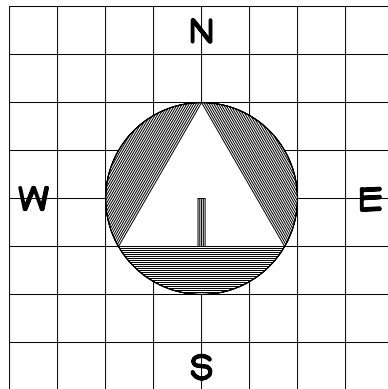

TENANT IMPROVEMENTS FOR:

NORTHBRIDGE CENTER GYM FACILITY

515 N. FLAGLER DR., SUITE P-100
WPB, FLORIDA

COPYRIGHT 2009
THESE DRAWINGS ARE FOR THE
EXCLUSIVE USE OF GLIDDEN SPINA
& PARTNERS, INC. AND MAY NOT BE
REPRODUCED, REPRODUCED OR USED
IN ANY MANNER WITHOUT THE
EXPRESS WRITTEN CONSENT OF
GLIDDEN SPINA & PARTNERS, INC.
ALL RIGHTS RESERVED.

sheet title: 1ST FLOOR - PAVILION
file name: NSY-PT-100.DWG

revisions:
1 02/14/12

project no: 11040
date: 02/14/12
drawn by: BJJOE
checked by: KS

A-1.1

GLIDDEN • SPINA & PARTNERS
ARCHITECTURE • INTERIOR DESIGN, INC.

PHONE : 561.684.6844 • FAX : 561.684.5594 • E-MAIL : info@gsp-architects.com
1401 FORUM WAY, SUITE 100 • WEST PALM BEACH, FLORIDA 33401
FL License: #A26001602 Benjamin John Glidden, III #86536
Kath M. Spina #R13419